



SUNSHINE COAST REGIONAL DISTRICT

ADDENDUM NO.1

Request for Proposal No. 18 358

Roof Replacement for Frank West Hall & Cliff Mahlman Fire Hall

Date: January 17, 2018

This addendum forms part of the contract documents and shall be read, interpreted, and coordinated with all other parts. The costs of all work contained herein shall be included in the tender submission. The following revisions, clarifications, changes, additions, or deletions supersede the information contained in the original documents to the extent referenced and shall become part thereof:

Number of pages including attachments: 2

Item No.1: Hours of Work

1. Delete 1.10.2.1 of Section 01 00 00 General Requirements in its entirety and replace with:
2. Perform Work between 7:00 AM to 18:00, Monday through Saturday, unless otherwise approved by Owner.
3. Delete 1.7.2 of Section 01 11 00 Summary of Work in its entirety and replace with:
Perform Work between 7:00 AM to 18:00, Monday through Saturday, unless otherwise approved by Owner.

Item No.2 Definition

Addition of new term in item 1.1

“**Holiday**” means Sunday, Christmas Day, Boxing Day, BC Day, Good Friday, Easter Monday, Victoria Day, Canada Day, British Columbia Day, Labour Day, Remembrance Day, New Year’s Day and any day set by the Parliament of Canada or by the Legislature as a public holiday;

Item No.2: Appendix 3 Drawings

Delete: Roof Plan Drawing R-1 and replace with attached roof plan R-1 Revised.

Item No.3: General

Please be advised that:

1. The fire hall bay doors; west entrance and west parking area must remain clear at all times, in case of emergencies. The fire department is able to accommodate minimal closures if required, but must be contacted first.
2. The hall will remain open to individuals or groups during the construction, please ensure that the side parking lot remain clear of materials and debris and the entrance and exists are available for our patrons use.

Item No.4:General

Please be advised that the side of the parking lot is used as a pickup / drop off zone for the adjacent school. Please stage material and debris storage at the back of the building. The Regional District will advise the school during construction that our parking lot will be unavailable.

Item No.5: Drawings

Question: It appears on the drawings there are two different profiles for ridge caps, is this an oversight or is it the way it should be? Is it for the ridge and hip?

Answer: To have a hook on both sides is difficult to hook up, we are just trying to make it simpler.

Addendum No.1 is issued prior to receipt of submission and shall form part of the contract documents. The revisions shall clarify the information contained in the original Proposal documents issued on December 12, 2018.

If you have any questions regarding the above, please contact the undersigned.

Vanessa Schilling, Buyer
Sunshine Coast Regional District

M:\PROJECTS\19501-19750\19652_FRANK WEST HALL - CLIFF MAHLMAN FIRE HALL\VR17-077SP_REPLACE\04_CAD\02_WORKING\VR17-077SP-19652_CLIFF MAHLMAN FIRE HALL.DWG

EXISTING ROOF COMPOSITION(S):

ROOF AREA 1.1

1X4 WOOD BOARD
1 PLY #15 FELT DRY NAILED
METAL PANELS

ROOF AREA 1.1

EXISTING 1X4 WOOD BOARD
NEW 0.5" PLYWOOD SHEATHING
NEW 1 PLY UNDERLAYMENT SHEET
NEW STANDING SEAM METAL PANELS

ROOF AREA (SQ. FT.)

A - 4,120

TOTAL ROOF AREA (SQ. FT.)

4,120

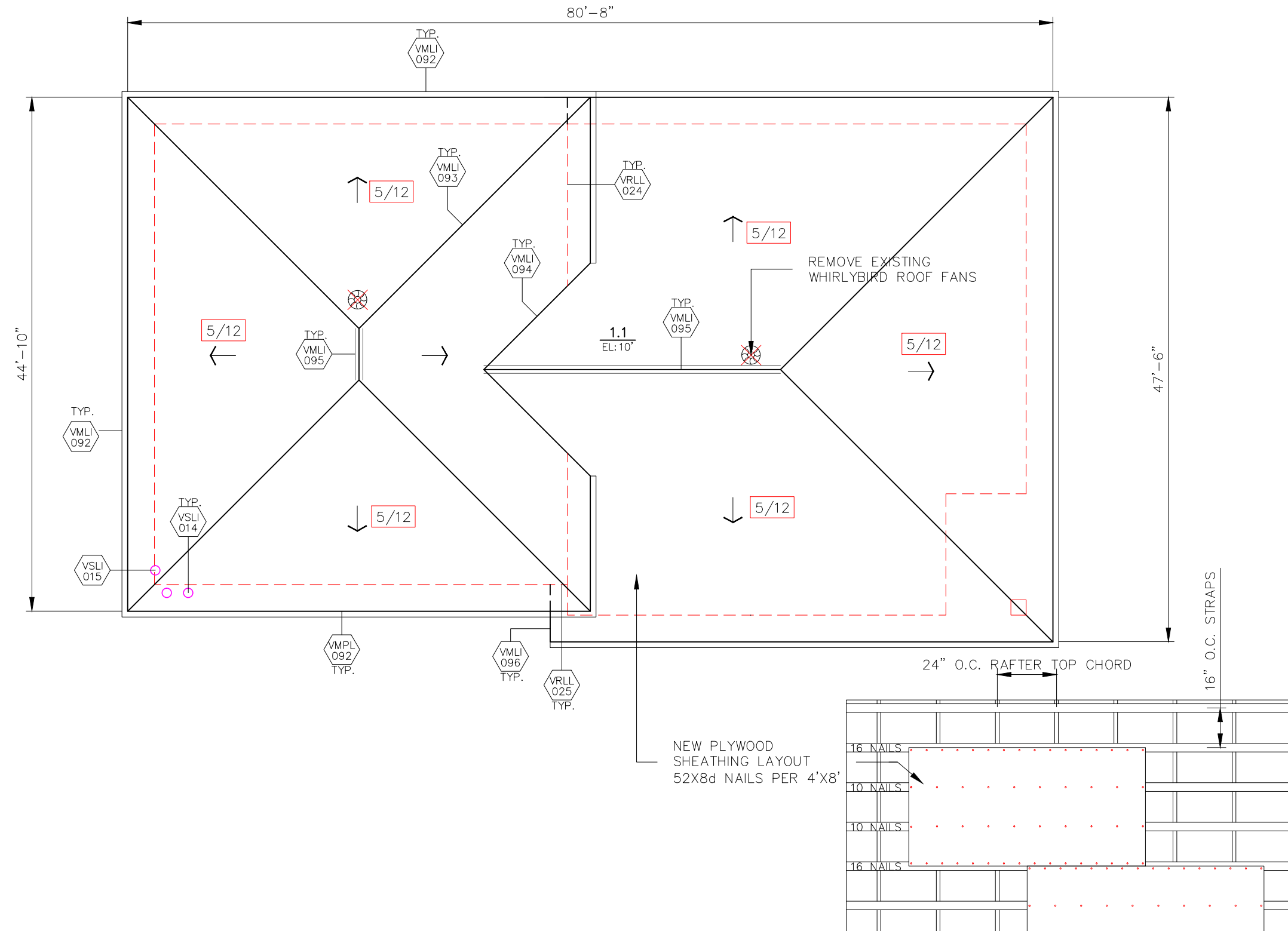

LEGEND

ROOF PROJECTIONS:

- | | |
|------------------------------------|---------------------------------|
| ▲ ANTENNA | ⊠ HVAC UNIT ON SLEEPERS |
| ⊥ BREATHER | ⌞ LADDER |
| ⊗ CAPPED STACK | ⊞ LIGHT POST |
| ◄ CHANGE IN ELEV. | ⊠ PIPE SUPPORT |
| ⊠ CHIMNEY | ⊞ PITCH POCKET |
| — CONDUIT LINE | ● PLUMBING OR SOIL STACK |
| — CONTROL JOINT | RA ROOF ANCHOR |
| ⊕ DRAIN | ⊞ SATELLITE DISH |
| ⊗ EXHAUST FAN ON CURB | ⊞ SCUPPER |
| — EXPANSION JOINT | ⊞ SECURITY CAMERA |
| ⊞ EXPLOSION HATCH | ⊞ SKYLIGHT |
| ⊞ FLAGPOLE | ← SLOPE |
| — GAS PIPELINE | ⊞ SQUARE VENT |
| ⊞ GOOSENECK VENT | ⊞ SQUARE VENT ON OVERSIZED CURB |
| ⊞ GOOSENECK VENT ON OVERSIZED CURB | ⊞ TALLCONE OR "B" VENT |
| ⊞ HATCH | ⊞ TALLCONE OR "B" VENT ON CURB |
| ⊞ HVAC UNIT | ⊞ UNUSED OPENING |
| ⊞ HVAC UNIT ON CURB | ⊞ WALKWAY PADS |

DRAINAGE:

- | | |
|-------------------------------|----------------------------------|
| ⊞ TAPERED INSULATION LAYOUT | ⊞ NEW ROOF DRAIN TO BE INSTALLED |
| ← DIRECTION OF WATER DRAINAGE | ⊞ INSULATION SUMP |
| | ⊞ INSULATION CRICKET |

NOTE: CONTRACTOR RESPONSIBLE FOR VERIFICATION OF ALL DIMENSIONS AND MEASUREMENTS TO OWN SATISFACTION. © 2019 BY IRC GROUP INC.

irc IRC BUILDING SCIENCES GROUP BC INC.
VANCOUVER • LONDON • MISSISSAUGA • OTTAWA • CALGARY
TOLL FREE: 1-888-607-5245 TEL: 604-295-8070
WWW.IRCGROUP.COM FAX: 604-279-9644

TITLE: ROOF PLAN
CLIENT: SUNSHINE COAST REGIONAL DISTRICT
PROJECT: FRANK WEST HALL / CLIFF MAHLMAN FIRE HALL
1246 CHASTER ROAD
GIBSONS, BC

IRC #:	19652	NORTH:
W.O.#:	VR17-077SP	
SCALE:	1" = 10'	DWG.#: R1(REV.1)
DATE:	JULY/2018	
DRN. BY:	B.W.	
CHK. BY:	M.K./D.W.	