

coast current



Fall 2013—Quarterly information for residents of the Sunshine Coast

Your Opinion on Food Matters!

The Sunshine Coast Regional District (SCRD) is currently assembling the major components of its Agricultural Area Plan for the Sunshine Coast.

The Plan is a strategy and policy framework to guide ongoing decision making about agriculture within the Sunshine Coast Regional District.

Expanding agriculture and food production is a key goal within the region. The SCRD's Sustainability Plan, *We Envision*, identifies developing an Agricultural Area Plan as an integral step to achieving local food security, and one of 13 major strategies for moving the region toward sustainability.

We Envision calls for increasing the amount of, and access to, locally grown and produced food. The sustainability plan also identifies the need to grow and diversify the regional economy, including stimulating the agriculture sector and localizing food production. To address this growing concern and initiate a region-wide dialogue about agriculture, the SCRD (including member municipalities the District of Sechelt and Town of Gibsons) is working on developing an Agricultural Area Plan under a 50/50 funding arrangement with the Investment Agriculture Foundation of BC, and its funding partners the BC Ministry of Agriculture, and Agri-Food Canada.



The Sunshine Coast Agricultural Area Plan provides an opportunity for the agricultural community, including local farmers, food processors and retailers, and other interested stakeholders within the community to work together to articulate a shared vision for the future of agriculture in the region and the steps needed to achieve this vision.

As part of Stages II and III of the Plan, Sunshine Coast citizens will have a number of opportunities to help develop and refine the Plan. Workshops and a speaker series are being planned for this Fall.

In the mean time, why not take the survey at www.scrd.ca/agriculture for a chance to win a local food basket!

Your opinion on agriculture and local food production is critical to determining how our community grows.



Fall/Winter Recreation Guide

Sunshine Coast residents can look to their Fall/Winter recreation guide for information on hundreds of leisure programs and activities being offered in Fall 2013 and Winter 2014.

The guide includes a wide range of programs including arts and culture, fitness and sports activities, skating and swimming lessons, information about special events, programs for seniors, and persons with specific needs and much more.

"The recreation guide is a resource for recreation on the Sunshine Coast," says Bruce Bauman, SCRD Recreation Services Manager. "Local recreation staff are eager to support participants in achieving their goals and committing to a healthier lifestyle by getting at least 30 minutes of activity every day."

The SCRD's Recreation Division offers a variety of drop in programs and memberships for those individuals who are looking for flexibility in their busy lives, or who are seeking out more affordable recreation options.

According to the BC Ministry of Health, physical activity and healthy eating can help reduce the risk of many conditions including heart disease, obesity, and breast cancer. The reduction in risk is comparable to the avoidance of tobacco use.

In order to meet the needs of a growing and diverse community, the SCRD also maintains an online registration system that enables residents to access recreation services efficiently and effectively from their home computer anytime of the day.

Visit www.scrd.ca/recreation for a copy of the 2013-2014 Fall and Winter Recreation Guide.

Civic Addressing

The Property Information and Mapping Division of the Sunshine Coast Regional District maintains a formal civic addressing system for all Electoral Areas including the Town of Gibsons, the District of Sechelt, the Sechelt Indian Government District, and the Islands. Civic addresses are generally issued at the time of application for a building permit.

Emergency services can only help you if they can locate you. It is important that the location of your civic address sign allows emergency vehicles to find your driveway at night or in bad weather.

Below are some simple guidelines for displaying your civic address. These guidelines should be adjusted to suit the conditions of your property:

- Use a white background for the sign
- Include dark or reflective numbers
- Make sure that the numbers are at least 3 inches high

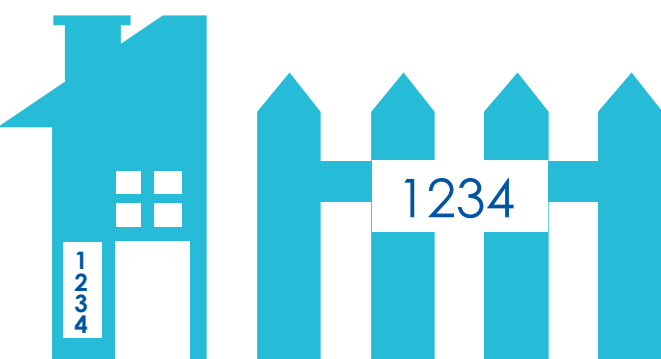
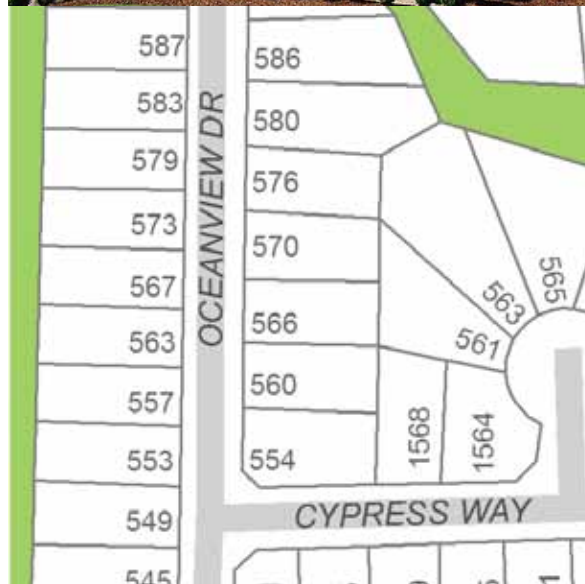

For more information on civic addressing, go to www.scrd.ca/Addressing, or contact 604-885-6805.

twitter
sunshinecoastrd
www.scrd.ca